

GRID BRACKET 90°

USER MANUAL

Admiral Staging the Netherlands
www.admiralstaging.com +31 534 301 201

SCOPE

This grid bracket is designed to mount two aluminum 50 mm tubes together in a 90 degrees angle.

WARNING

Inspect this product before use. In case of material defects, this product should be taken out of service.

MAINTENANCE

Please do not use aggressive cleaning agents such as solvents and/or corrosive substances. Clean the product with a cloth with a soft detergent.

After cleaning the product, dry it with a soft cloth. Check the product for worn, tear and/or lost items.

WARNING

By wear and/or missing of the proper components this product should be immediately taken out of service. Consult your supplier for advise.

Repair / maintenance is only permitted by a qualified person. In case of doubt, consult your supplier.

BUILD A GRID

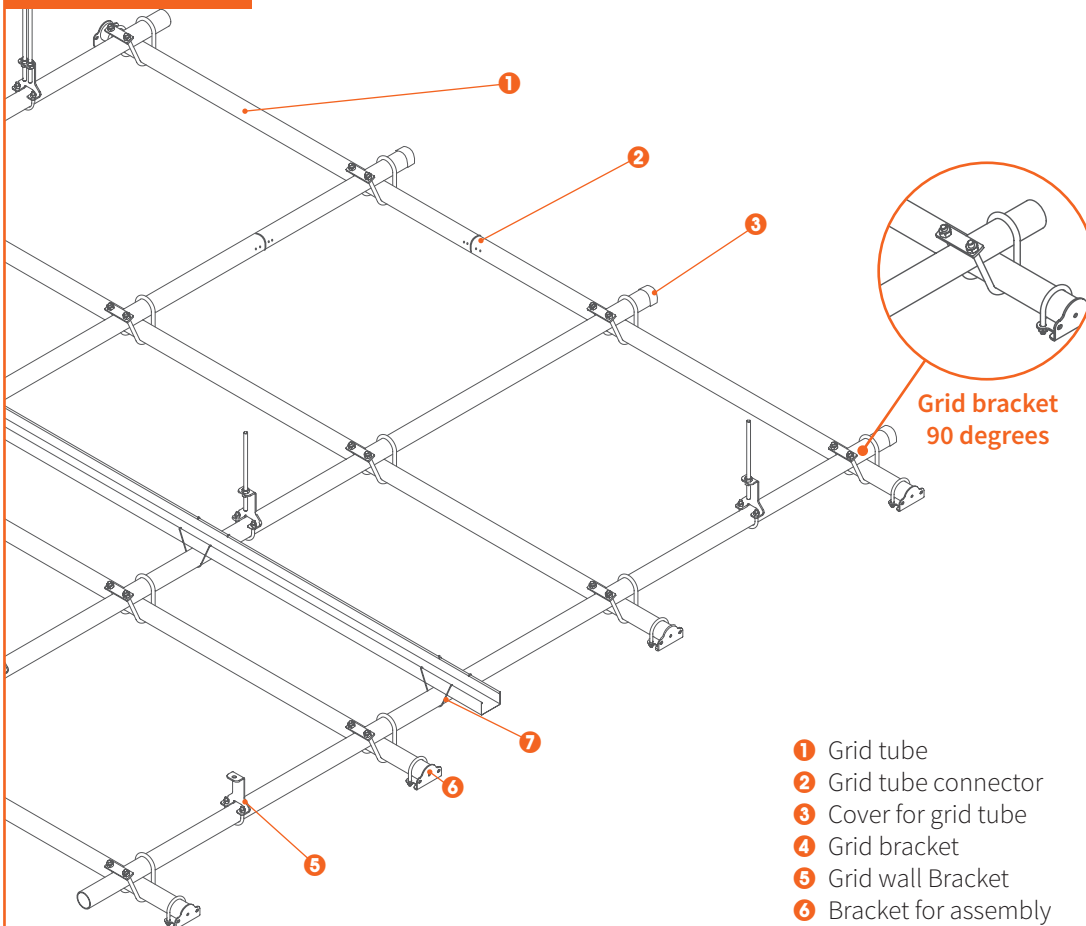

- 1 Grid tube
- 2 Grid tube connector
- 3 Cover for grid tube
- 4 Grid bracket
- 5 Grid wall Bracket
- 6 Bracket for assembly gutter onto gridtube

INSTALL

STEP 1

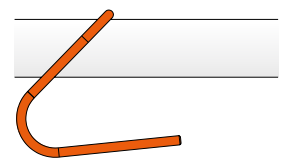

Hang the bracket onto the upper tube.

STEP 2

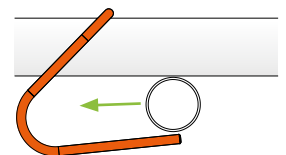

Slide the lower tube into the bracket .

STEP 3

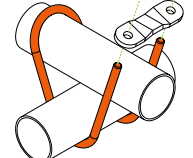

Screw the locking plate onto the bracket using self locking nuts.